

DATE	5/14/04	BY	JRE
REVISIONS	EXHIBIT "A" REVISION	APPROVED	JPM
PROJ. #	00007	DATE	6/22/04

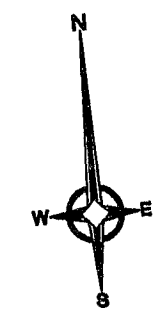

HAMPTON INN  
ENNR ENTERPRISES  
C.E.S. PLAT 3-3-94

**PALMETTO POINTE CONDOMINIUMS  
PLANNED DEVELOPMENT**  
US HIGHWAY 123, CLEMSON, SOUTH CAROLINA

TABLE OF DATA

PROPOSED ZONING	PLANNED DEVELOPMENT (PD)
SITE AREA	1.573 ACRES
MINIMUM LOT AREA FOR STRUCTURE	1.573 ACRES
LOT WIDTH	265.43 FEET
MINIMUM BUILDING SETBACKS / YARDS	SEE PLAN
MAXIMUM DEVELOPMENT DENSITY	20 UNITS PER ACRE
MAXIMUM STRUCTURE HEIGHT	50 FEET
IMPERVIOUS SURFACE RATIO* (SEE DET. 2/SK1)	59.5% OF TOTAL LAND AREA
OFF-STREET PARKING	60 SPACES
OPEN SPACE RATIO* (SEE DET. 3/SK1)	36.8% OF TOTAL LAND AREA
BUFFER YARDS, SCREENING AND LANDSCAPING	SEE PLAN
SIGNS	SEE PLAN

\* INDICATES THOSE ITEMS WHICH WERE CALCULATED DIRECTLY FROM CADD DESIGN FILE (COORDINATE GEOMETRY METHODS)

DEVELOPER: J & P ENTERPRISES INC., GASTONIA, NORTH CAROLINA

**QualityFirst**  
**ISOM ASSOCIATES P.A.**  
ARCHITECTURE • ENGINEERING • PLANNING • INTERIORS  
1311 Collegiate Drive  
Wilmington, NC 28407  
Phone: 336-836-4007  
Fax: 336-836-4916



LAKE HARTWELL  
US ARMY CORPS OF ENGINEERS

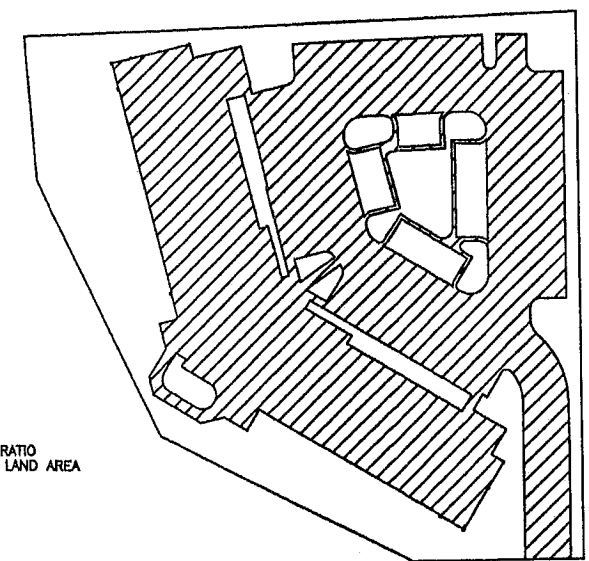

IMPERVIOUS AREA RATIO  
= 59.5% OF TOTAL LAND AREA

U.S. HIGHWAY 123  
160' RIGHT-OF-WAY  
POSTED SPEED = 35 MPH

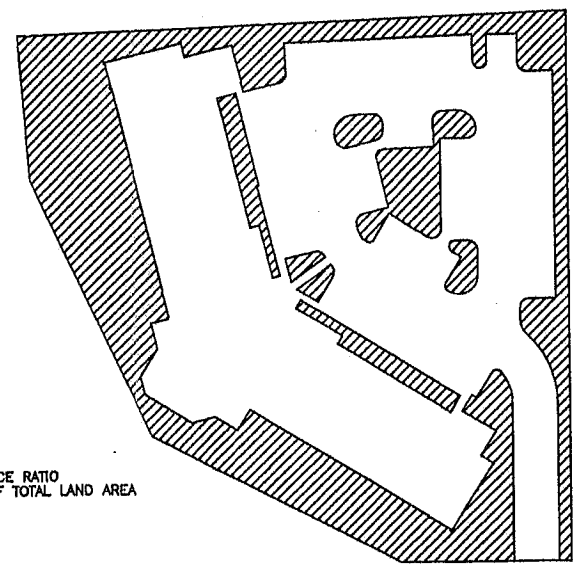

OPEN SPACE RATIO  
= 36.8% OF TOTAL LAND AREA

**EXHIBIT "A"**

PLANNED DEVELOPMENT PLAN  
CLEMSON TOWERS  
CONDOMINIUMS

ORIGINAL IN FILE R04-03